

TENANT LIST

SUITE A ----- ATLANTA HOSIERY COMPANY ----- 22,500 SF
 SUITE D ----- SEALPAK ASSOCIATES ----- 15,240 SF
 SUITE E ----- (AVAILABLE) ----- 10,050 SF
 SUITE G ----- OLVERA'S FURNITURE ----- 10,050 SF
 SUITE J ----- (AVAILABLE) ----- 17,200 SF

SUITE K ----- (AVAILABLE) ----- 13,860 SF
 SUITE L ----- AMERISINK ----- 13,927 SF
 SUITE M ----- CAMPUS CARRIERS ----- 15,850 SF
 SUITE N ----- A-1 HORTON'S MOVING SERVICE ----- 16,000 SF

EXCEPT WITH RESPECT TO THE OBLIGATIONS OF LANDLORD WHICH ARE EXPRESSLY PROVIDED IN THE LEASE, LANDLORD HAS MADE NO AGREEMENT, REPRESENTATION OR WARRANTY WITH RESPECT TO THE STATUS OR EXISTENCE OF ANY LEASE, OCCUPANCY OR USAGE OF ANY SPACE, OR THE EXISTENCE, DESIGN OR LOCATION OF ANY BUILDINGS, IMPROVEMENTS, PARKING AREAS, CURB CUTS, DRIVES OR OTHER COMMON AREAS WITH RESPECT TO THE SHOPPING CENTER OR ANY OUTPARCELS OR OTHER PROPERTY. LANDLORD BELIEVES THAT THE INFORMATION CONTAINED WITHIN THIS DRAWING IS PRESENTLY CORRECT, BUT LANDLORD MAKES NO WARRANTY, REPRESENTATION OR GUARANTEE AS TO ITS ACCURACY OR WHETHER IT WILL REMAIN AS CONFIGURED, AND LANDLORD RECOMMENDS THAT ALL INFORMATION BE FIELD VERIFIED PRIOR TO DESIGN AND CONSTRUCTION.

134,677 SF TOTAL
159 PARKING SPACES
PARKING RATIO:
1.18 SP/1,000 SF

1 ---- (AVAILABLE)
 2 ---- (AVAILABLE)
 3 ---- (AVAILABLE)
 4 ---- A-1 HORTON'S MOVING SERVICE

TULANE DRIVE

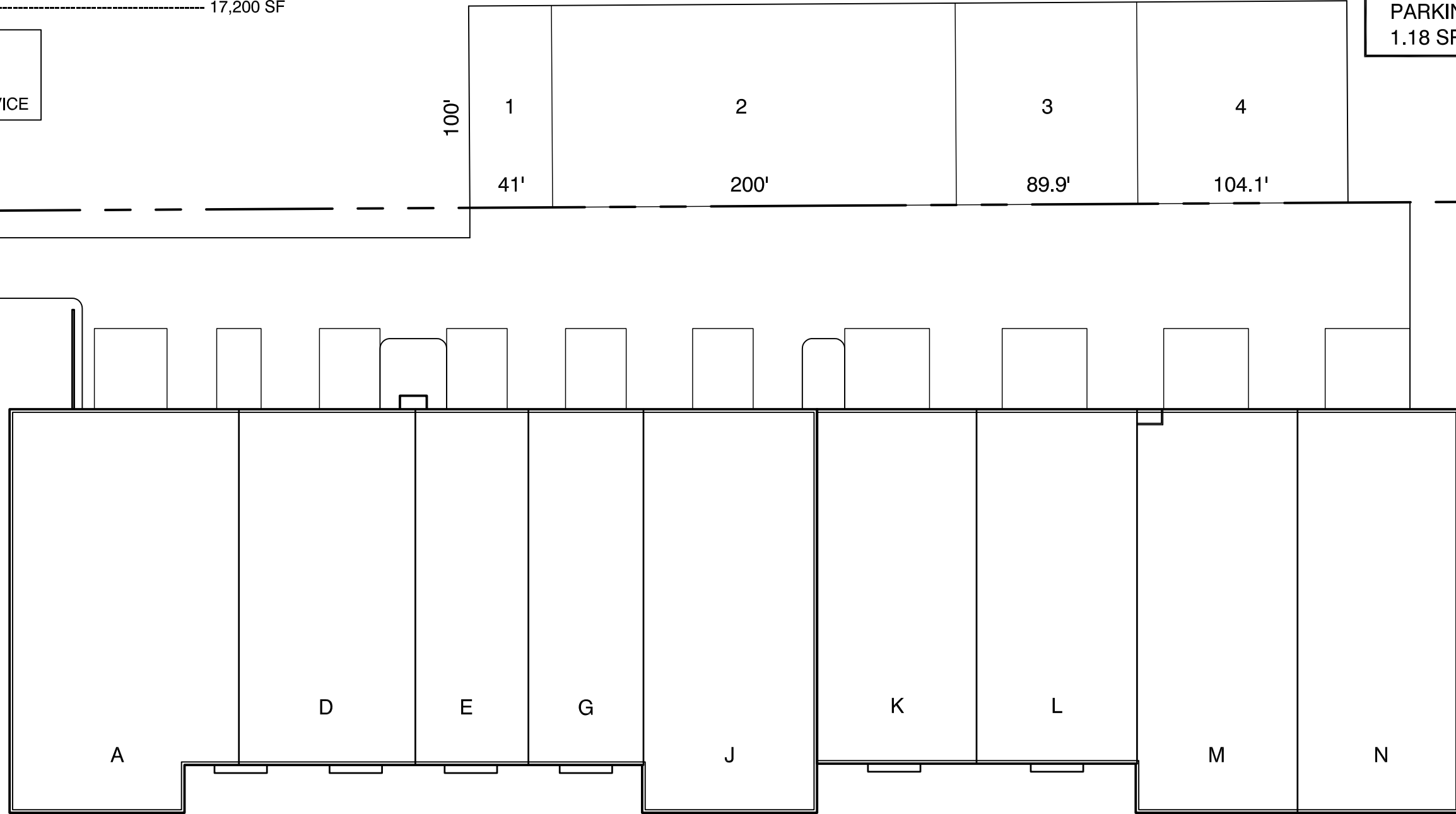

5315 TULANE DRIVE: LEASING PLAN

5315 TULANE DRIVE
 ATLANTA, GA 30336

DRAWN BY: CO/KA

DATE: 01/04/16



1100 SPRING STREET NW SUITE 550
 ATLANTA, GEORGIA 30309-2848
 TEL (404) 876-5511 FAX (404) 875-2629