

EXCEPT WITH RESPECT TO THE OBLIGATIONS OF LANDLORD WHICH ARE EXPRESSLY PROVIDED IN THE LEASE, LANDLORD HAS MADE NO AGREEMENT, REPRESENTATION OR WARRANTY WITH RESPECT TO THE STATUS OR EXISTENCE OF ANY LEASE, OCCUPANCY OR USAGE OF ANY SPACE, OR THE EXISTENCE, DESIGN OR LOCATION OF ANY BUILDINGS, IMPROVEMENTS, PARKING AREAS, CURB CUTS, DRIVES OR OTHER COMMON AREAS WITH RESPECT TO THE SHOPPING CENTER OR ANY OUTPARCELS OR OTHER PROPERTY. LANDLORD BELIEVES THAT THE INFORMATION CONTAINED WITHIN THIS DRAWING IS PRESENTLY CORRECT, BUT LANDLORD MAKES NO WARRANTY, REPRESENTATION OR GUARANTEE AS TO ITS ACCURACY OR WHETHER IT WILL REMAIN AS CONFIGURED, AND LANDLORD RECOMMENDS THAT ALL INFORMATION BE FIELD VERIFIED PRIOR TO DESIGN AND CONSTRUCTION.

9,277 SF TOTAL
36 PARKING SPACES
PARKING RATIO: 3.88 SP/1,000 SF

480 PHARR ROAD PREMISES

465 EAST PACES FERRY ROAD PREMISES

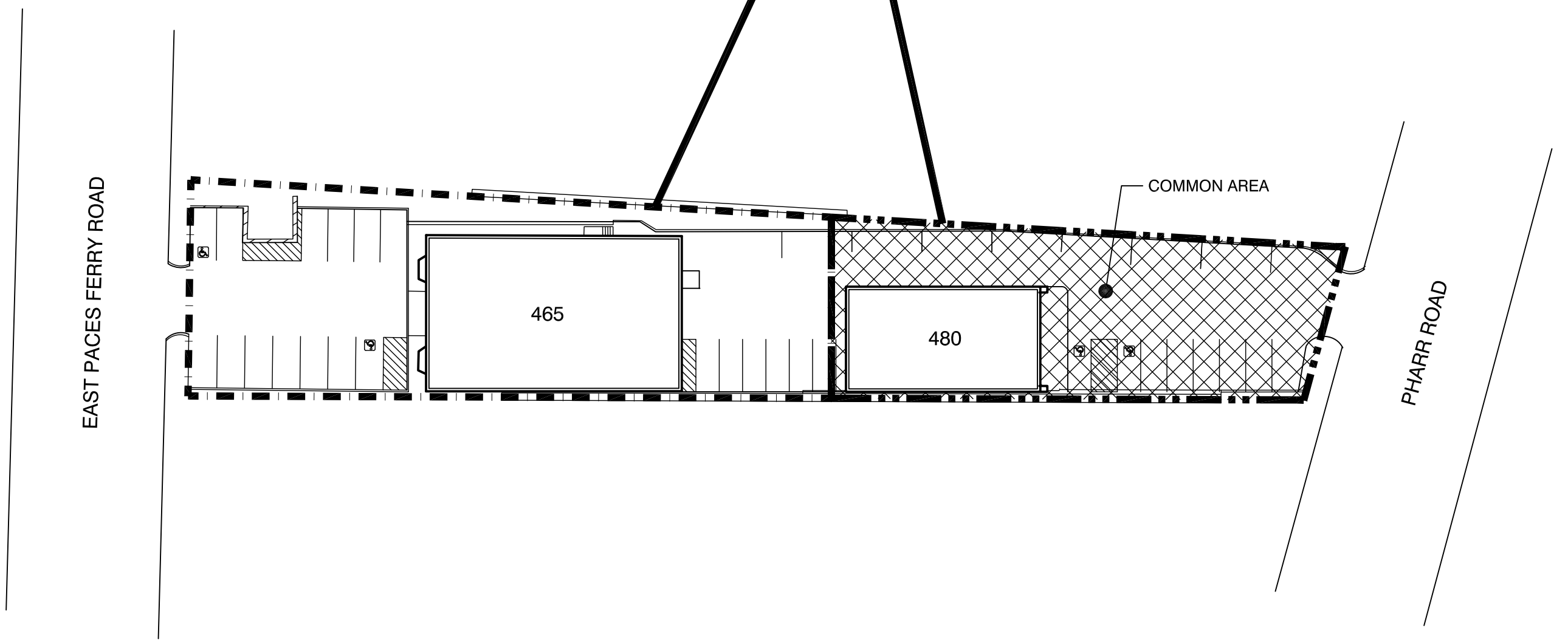

USER: conall - Nov 07, 2012 - 1:31pm
S:\CONSTRUCTION\AutoCAD\As_Built Drawings\Retail\East Paces Ferry Rd & Pharr Road\Site Plan\EAST PACES FERRY 465 & 480 Pharr Road_LEASING SITE PLAN.dwg



465 EAST PACES FERRY ROAD & 480 PHARR ROAD: LEASING PLAN

465 EAST PACES FERRY ROAD & 480 PHARR ROAD
ATLANTA, GA 30305

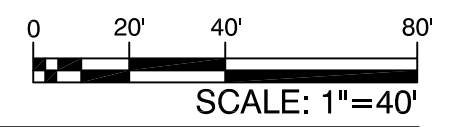

DRAWN BY: CO DATE: 11/07/12



1100 SPRING STREET NW SUITE 550
ATLANTA, GEORGIA 30309-2848
TEL (404) 876-5511 FAX (404) 875-2629