

**TENANT LIST**

442 EAST PACES FERRY RD. 1st --- STATE FARM ----- 1,821 SF  
 442 EAST PACES FERRY RD. 2nd --- STATE FARM ----- 1,054 SF  
 442 EAST PACES FERRY RD REAR -- VICTOR STRUMINGER ----- 702 SF

WHILE SELIG ENTERPRISES, INC. BELIEVES THE INFORMATION CONTAINED WITHIN THIS DRAWING TO BE CORRECT, WE MAKE NO WARRANTY OR GUARANTEE AS TO ITS ACCURACY. IT IS RECOMMENDED THAT ALL INFORMATION BE FIELD VERIFIED PRIOR TO DESIGN AND/OR CONSTRUCTION.

3,577 SF TOTAL
8 PARKING SPACES
PARKING RATIO: 2.24 SP/1,000 SF

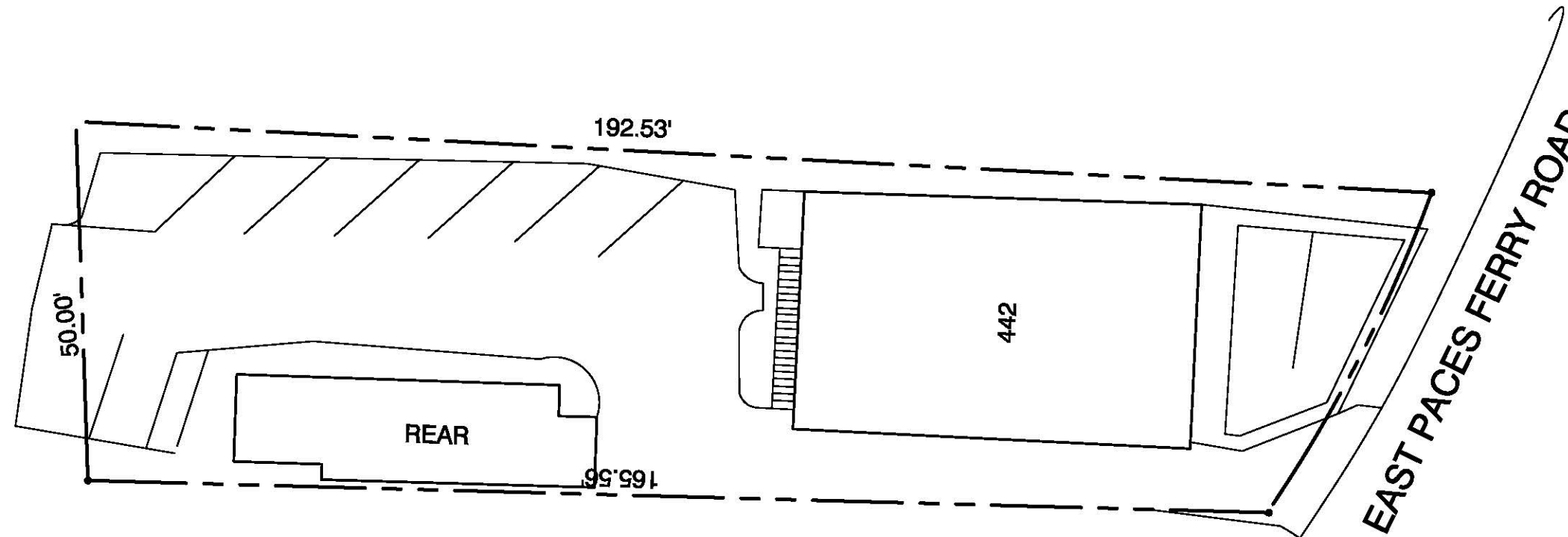

USER: drobison - Feb 20, 2012 - 11:28am  
 S:\CONSTRUCTION\AutoCAD\AutoCAD\Drawings\Westall\East\Phase 1\442.dwg



**EAST PACES FERRY RD & EAST SHADOWLAWN AVE: LEASING PLAN**

414 & 432 & 422 EAST PACES FERRY RD.  
 3077 & 3079 EAST SHADOWLAWN AVE.  
 ATLANTA, GA. 30305

SCALE: 1"=360'  
 DRAWN BY: D.ROBINSON DATE: 2/20/12  

 1100 SPRING STREET NW SUITE 550  
 ATLANTA, GEORGIA 30309-2848  
 TEL (404) 876-5511 FAX (404) 875-2829