



PACES CENTER

455 EAST PACES FERRY ROAD
ATLANTA, GA 30305

SUITE 330
317 SF

Conveniently located in Buckhead, 455 East Paces Ferry Road offers excellent access to East Paces Ferry Road and Pharr Road, as well as I-85 and GA-400. Smaller spaces are available with ample free parking. Located next to the Suzuki Preparatory School.

TOTAL SF	ZONING	ACCESSIBILITY	AVAILABLE
317	SPI-9 SA3	LOCKBOX	NOW

**EXCLUSIVELY
MARKETED BY:**

Jim Saine
(404) 898 9010
jsaine@seligenterprises.com

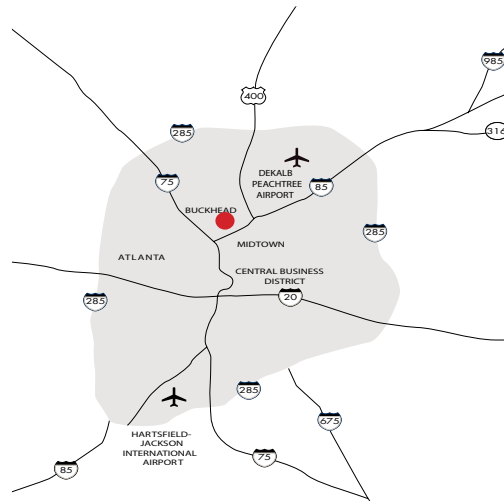

All measures, facts, and figures are subject to verification.

EXCEPT WITH RESPECT TO THE OBLIGATIONS OF LANDLORD WHICH ARE EXPRESSLY PROVIDED IN THE LEASE, LANDLORD HAS MADE NO AGREEMENT, REPRESENTATION OR WARRANTY WITH RESPECT TO THE STATUS OR EXISTENCE OF ANY LEASE, OCCUPANCY OR USAGE OF ANY SPACE, OR THE EXISTENCE, DESIGN OR LOCATION OF ANY BUILDINGS, IMPROVEMENTS, PARKING AREAS, CURB CUTS, DRIVES OR OTHER COMMON AREAS WITH RESPECT TO THE SHOPPING CENTER OR ANY OUTPARCELS OR OTHER PROPERTY. LANDLORD BELIEVES THAT THE INFORMATION CONTAINED WITHIN THIS DRAWING IS PRESENTLY CORRECT, BUT LANDLORD MAKES NO WARRANTY, REPRESENTATION OR GUARANTEE AS TO ITS ACCURACY OR WHETHER IT WILL REMAIN AS CONFIGURED, AND LANDLORD RECOMMENDS THAT ALL INFORMATION BE FIELD VERIFIED PRIOR TO DESIGN AND CONSTRUCTION.

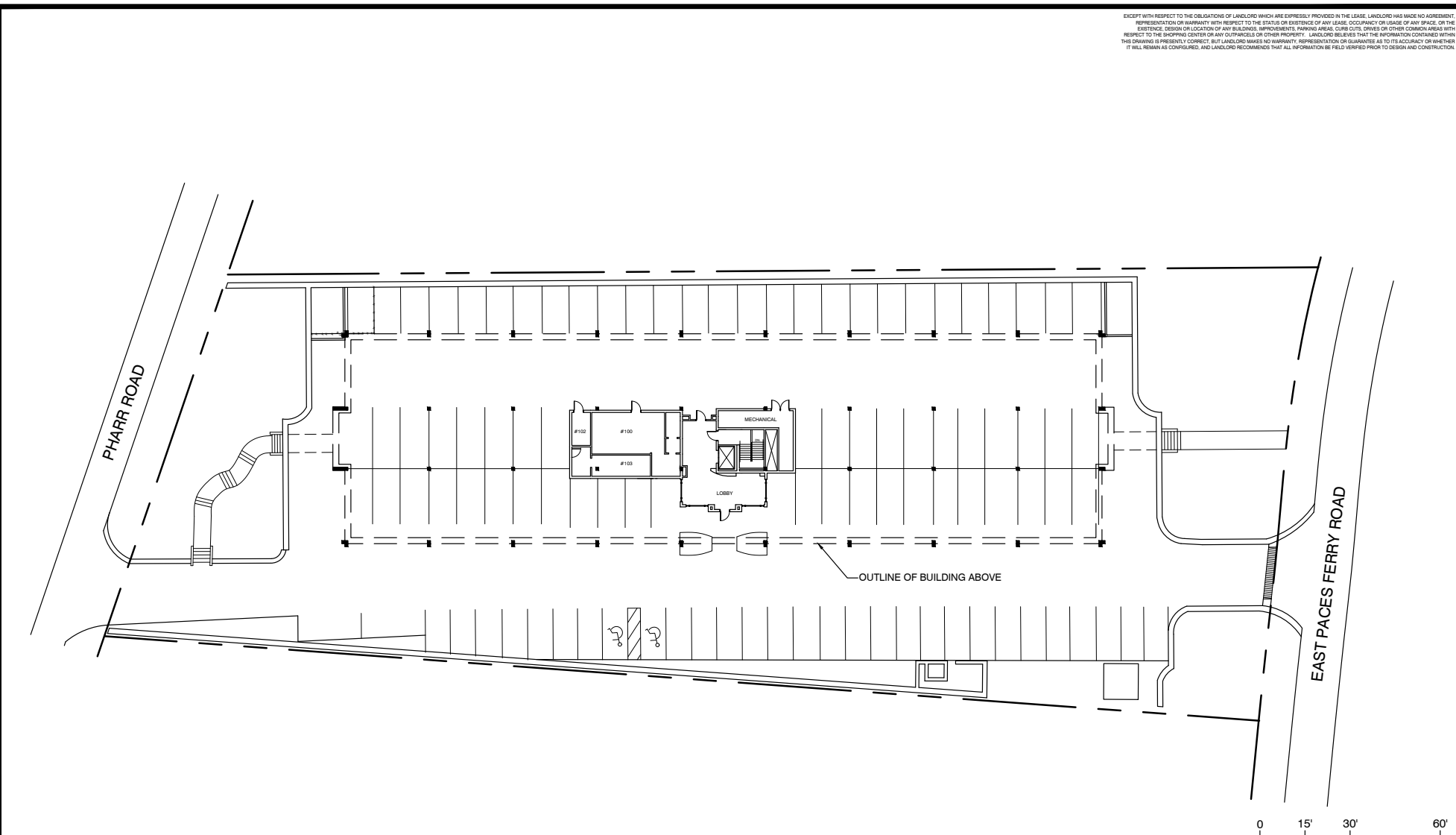

12/10/14
10:00 AM
C:\Users\ka\OneDrive\Desktop\WORKSPACE\455 East Paces Ferry\Site Plan\Site Plan.dwg
12/10/14 10:00 AM



PACES CENTER - SITE PLAN

455 EAST PACES FERRY ROAD
ATLANTA, GA 30305

DRAWN BY: KA

DATE: 12/10/14



1100 SPRING STREET NW SUITE 550
ATLANTA, GEORGIA 30309-2848
TEL (404) 878-5511 FAX (404) 875-2629

EXCEPT WITH RESPECT TO THE OBLIGATIONS OF LANDLORD WHICH ARE EXPRESSLY PROVIDED IN THE LEASE, LANDLORD HAS MADE NO AGREEMENT, REPRESENTATION OR WARRANTY WITH RESPECT TO THE STATUS OR EXISTENCE OF ANY LEASE, OCCUPANCY OR USAGE OF ANY SPACE, OR THE EXISTENCE, DESIGN OR LOCATION OF ANY BUILDINGS, IMPROVEMENTS, PARKING AREAS, CURB CUTS, DRIVES OR OTHER COMMON AREAS WITH RESPECT TO THE SHOPPING CENTER OR ANY OUTPARCELS OR OTHER PROPERTY. LANDLORD BELIEVES THAT THE INFORMATION CONTAINED WITHIN THIS DRAWING IS PRESENTLY CORRECT, BUT LANDLORD MAKES NO WARRANTY, REPRESENTATION OR GUARANTEE AS TO ITS ACCURACY OR WHETHER IT WILL REMAIN AS CONFIGURED, AND LANDLORD RECOMMENDS THAT ALL INFORMATION BE FIELD VERIFIED PRIOR TO DESIGN AND CONSTRUCTION.

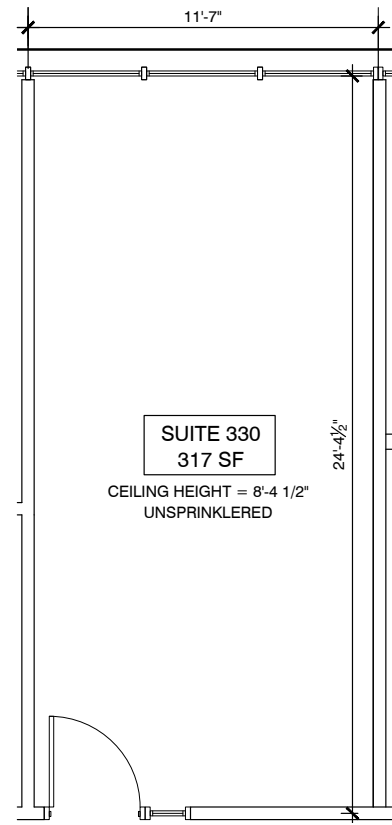

SCALE: 1/4" = 1'-0"

DRAWN BY: CO DATE: 03/30/21

UPPER PACES, INC. 303 N. 11th St. ATLANTA, GA 30309 OFFICE: 404.521.1200 FLOOR PLAN: 405 - 3rd Floor.dwg



PACES CENTER: SUITE 330 - FLOOR PLAN

455 EAST PACES FERRY ROAD, SUITE 330
ATLANTA, GEORGIA 30305

SELIG ENTERPRISES, INC. 1100 SPRING STREET NW SUITE 550
ATLANTA, GEORGIA 30309-2848
TEL (404) 876-5511 FAX (404) 875-2829

PACES CENTER

455 EAST PACES FERRY ROAD
ATLANTA, GA 30305

